

ITEM NO.	PART NUMBER	QTY.
1	PTKTFMVL15-001	1
2	PTKTFMVL15-002	1
3	PTKTFMVL15-003	1
4	ILF-FLR-EXT-1350	1
5	ILF-FLR-EXT-1262	1
6	PTKTFMVM15-005	2
7	PTKTFMVM15-004	2
8	16X20MM SPACER	8
9	16X10MM SPACER	6
10	M8 WASHER LARGE	8
11	M8X50 DOME HEAD BOLT	8
12	SCREW 10G X 1/2	16

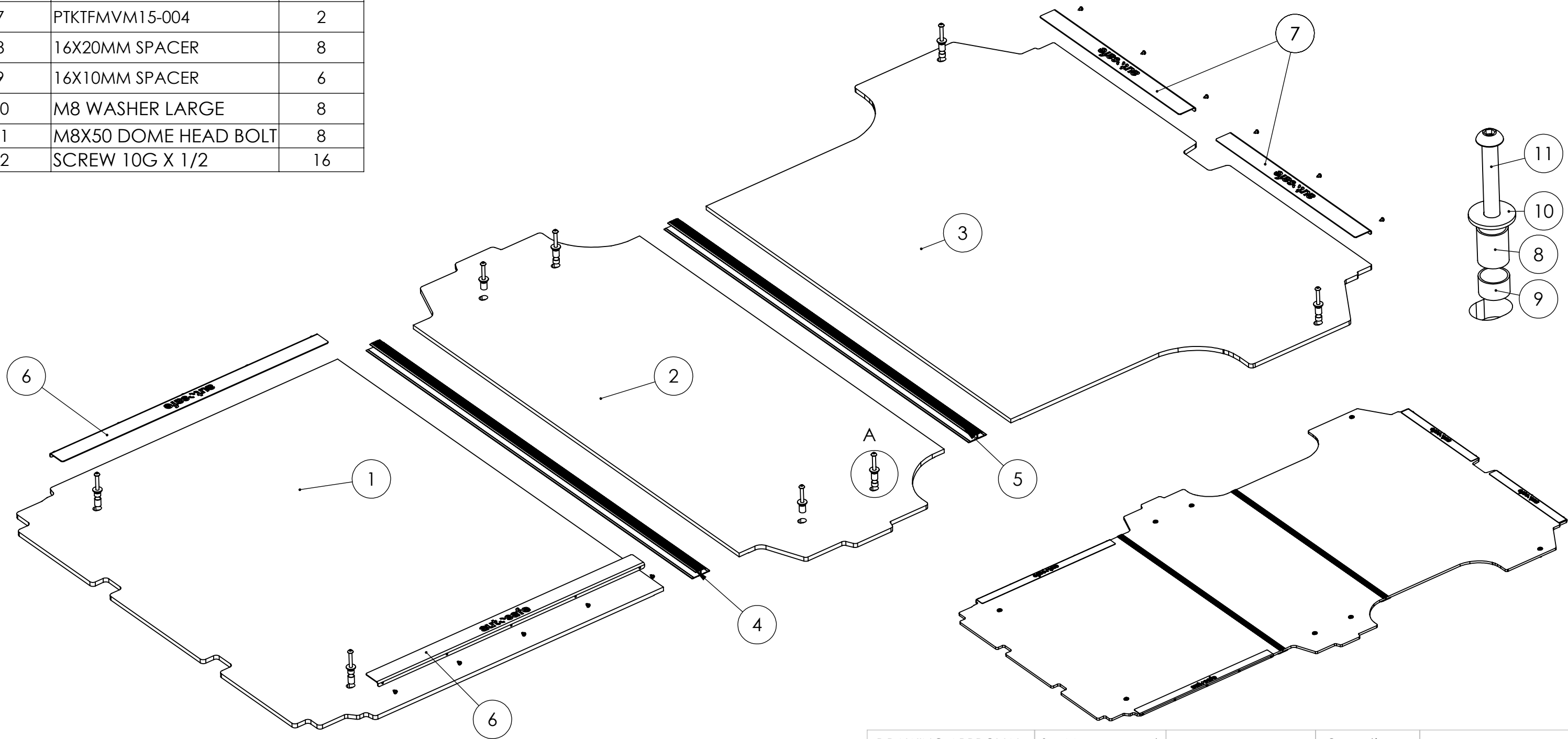

- 1-REMOVE ALL FACTORY TIE POINTS FROM CARGO FLOOR.
2-PLACE TIE POINTS IN GLOVE BOX.
3-STARING FROM REAR OF VEHICLE, PLACE PARTS INTO VEHICLE
IN ORDER SHOWN.

ITEM NO.	PART NUMBER	QTY.
1	PTKTFMVL15-003	1
2	ILF-FLR-EXT-1262	1
3	PTKTFMVL15-002	1
4	ILF-FLR-EXT-1350	1
5	PTKTFMVL15-001	1

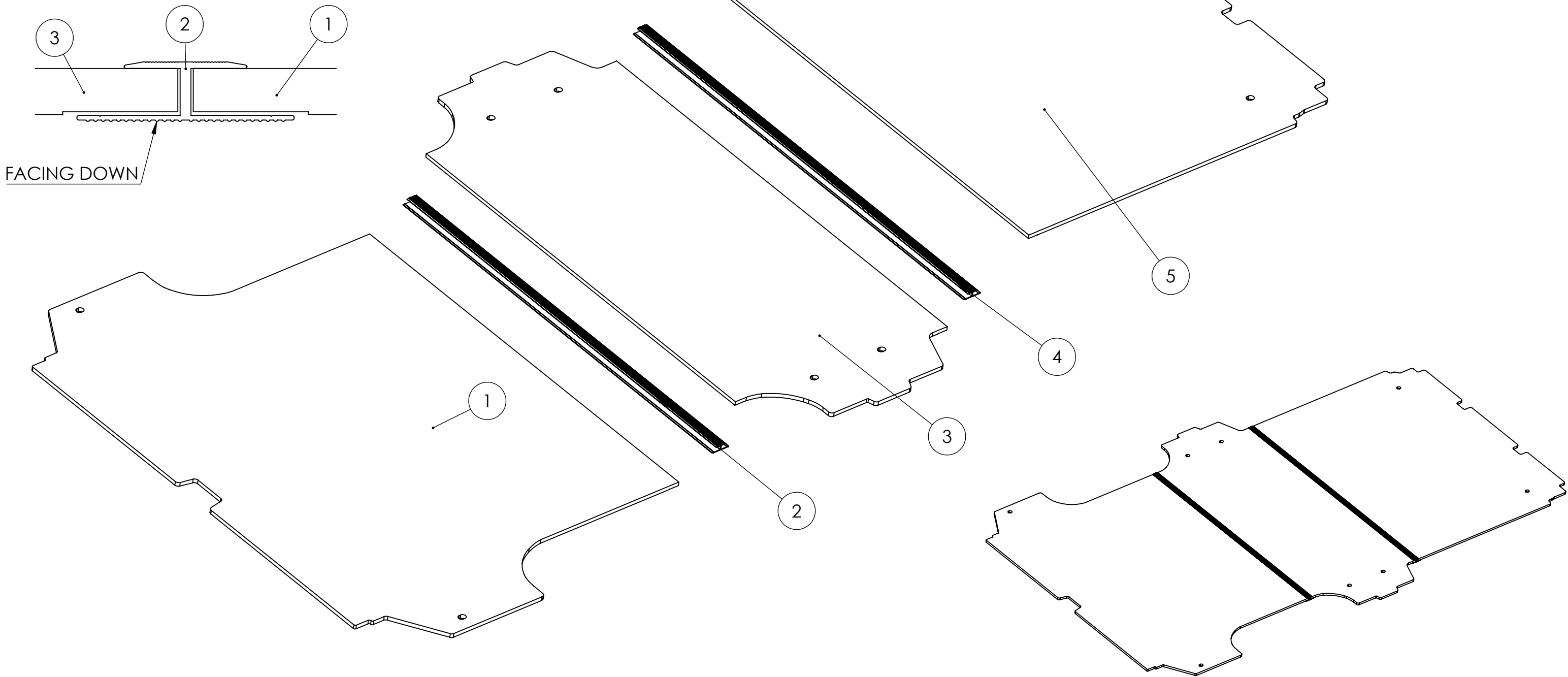

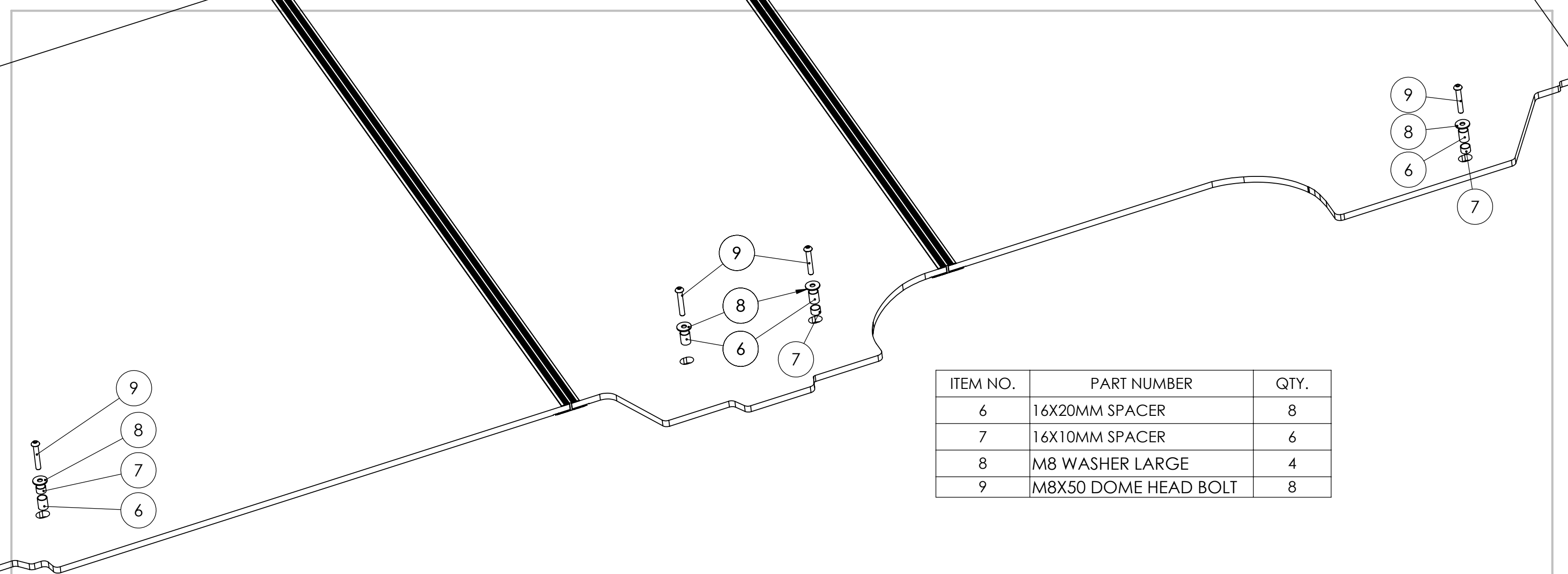

ITEM NO.	PART NUMBER	QTY.
6	16X20MM SPACER	8
7	16X10MM SPACER	6
8	M8 WASHER LARGE	4
9	M8X50 DOME HEAD BOLT	8

4-STRAIGHTEN AND ALIGN PANELS TO MATCH HOLES IN FLOOR.
5-PLACE SPACERS INTO HOLES ACCORDING TO DIAGRAM ABOVE.
6-PLACE WASHER OVER SPACERS.
7-SECURE PANELS TO FLOOR USING M8X50 DOME HEAD BOLTS.

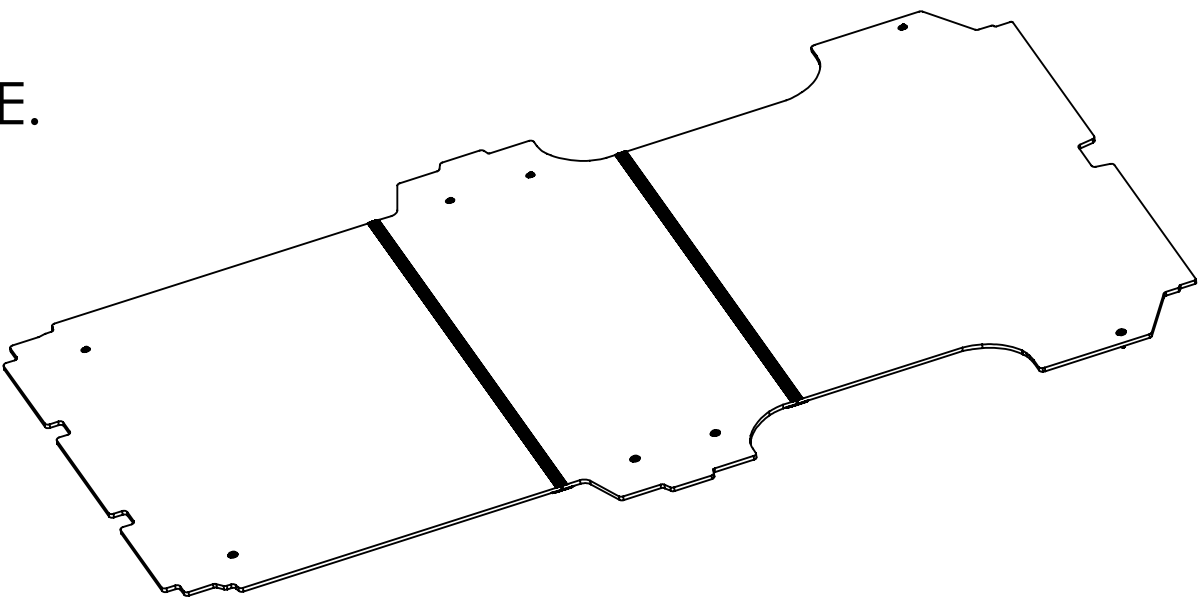

8-PLACE COVER PLATES INTO POSITION AS PER DIAGRAM BELLOW.
9-SECURE PLATES TO FLOOR USING SCREW 10GX1/2.

ITEM NO.	PART NUMBER	QTY.
6	PTKTFMVM15-005	2
7	PTKTFMVM15-004	2
12	SCREW 10G X 1/2	16

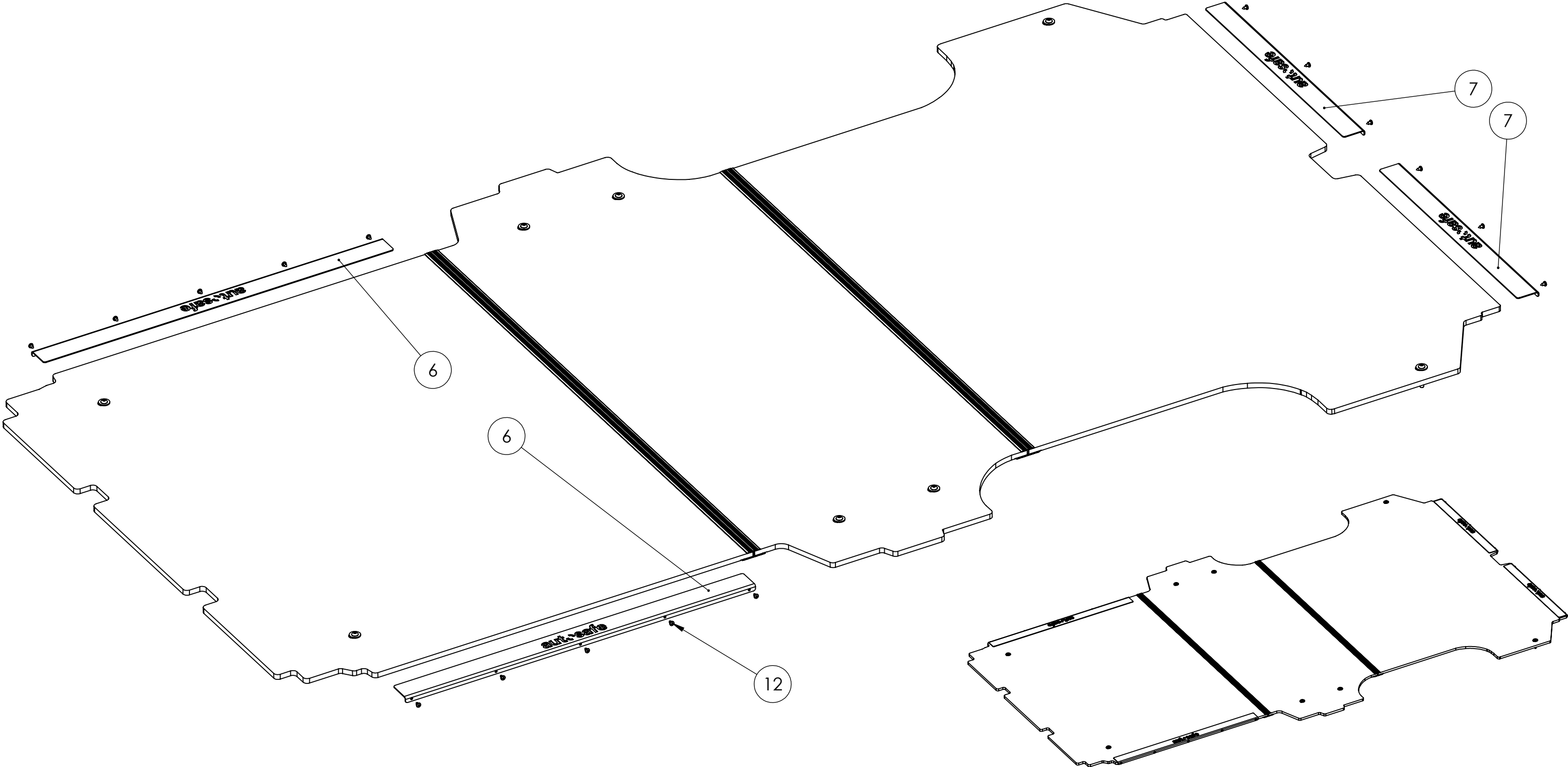

DRAWING APPROVAL	Snr.Management:	Operations:
Filename: PTKTFMVL15		
Vehicle		Job no:
Material	Mass (grms) WEIGHT:	Part no: