

(PTKT-SC500)  
(PTKT-SC850)

ITEM NO.	PART NUMBER	QTY.
1	PTKTFMVM15-002	1
2	PTKTFMVM15-001	1
3	PTKTFMVM15-003	1
4	PTKTFMVM15-004	2
5	PTKTFMVM15-005	2
6	ILF-JOINER-1252	1
7	ILF-JOINER-1648	1
8	16X20MM SPACER	8
9	16X10MM SPACER	4
10	M8 WASHER LARGE	8
11	M8X40 DOME HEAD BOLT	8
12	SCREW 10GX1/2	16

DRAWING APPROVAL	Snr.Management:	Operations:
------------------	-----------------	-------------

Filename: PTKTFMVM15

Vehicle MERCEDES VITO MWB 2015

Material

Mass (grms) WEIGHT:

Job no:

Part no:



PROPRIETARY AND CONFIDENTIAL

THE INFORMATION CONTAINED IN THIS DRAWING IS THE SOLE PROPERTY OF AUTOSAFE. ANY REPRODUCTION IN PART OR AS A WHOLE WITHOUT THE WRITTEN PERMISSION OF AUTOSAFE IS PROHIBITED.

Drawn by: P.LUIS

Scale SCALE: 1:20

Date 20/05/2021

- 1-REMOVE SPARE WHEEL JACK ASSEMBLY FROM D POST.  
2-REMOVE ALL TIE DOWN POINT ON FLOOR OF CARGO AREA.  
3- PLACE 1 INTO POSITION OVER WHEEL ARCHES.  
4-PLACE 6 7 INTO POSITION ENSURING LARGER FLANGES TO BOTTOM.

ITEM NO.	PART NUMBER	QTY.
1	PTKTFMVM15-002	1
6	ILF-JOINER-1252	1
7	ILF-JOINER-1648	1

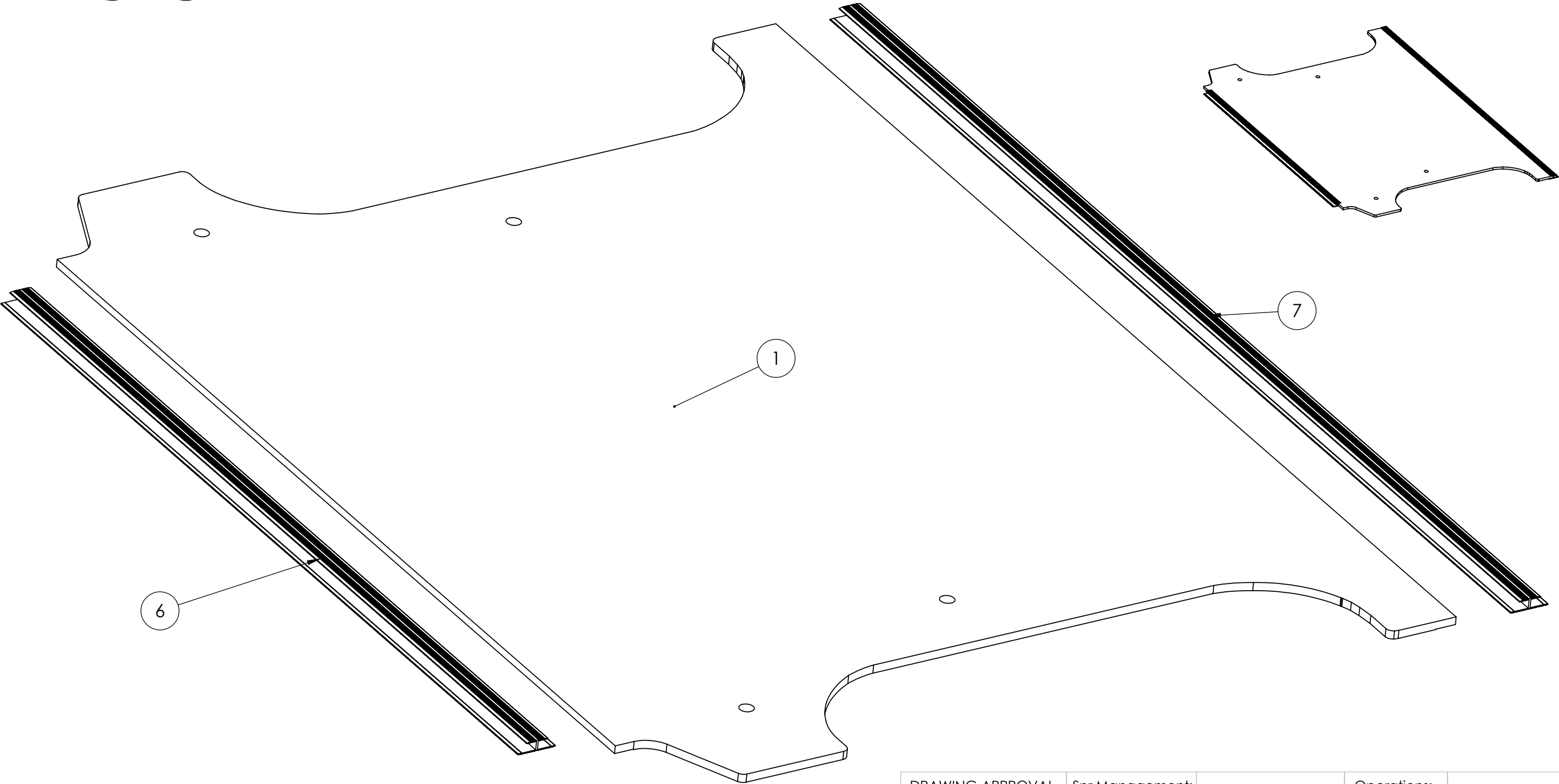

5-PLACE 2 3 INTO POSITION.

6-ENSURE BOARDS ARE PUSHED TIGHTLY AGAINST EACH OTHER.

7-ADJUST BOARDS UNTIL THE ARE ALIGNED WITH ANCHOR POINTS IN FLOOR AND EACH OTHER.

ITEM NO.	PART NUMBER	QTY.
2	PTKTFMVM15-001	1
3	PTKTFMVM15-003	1

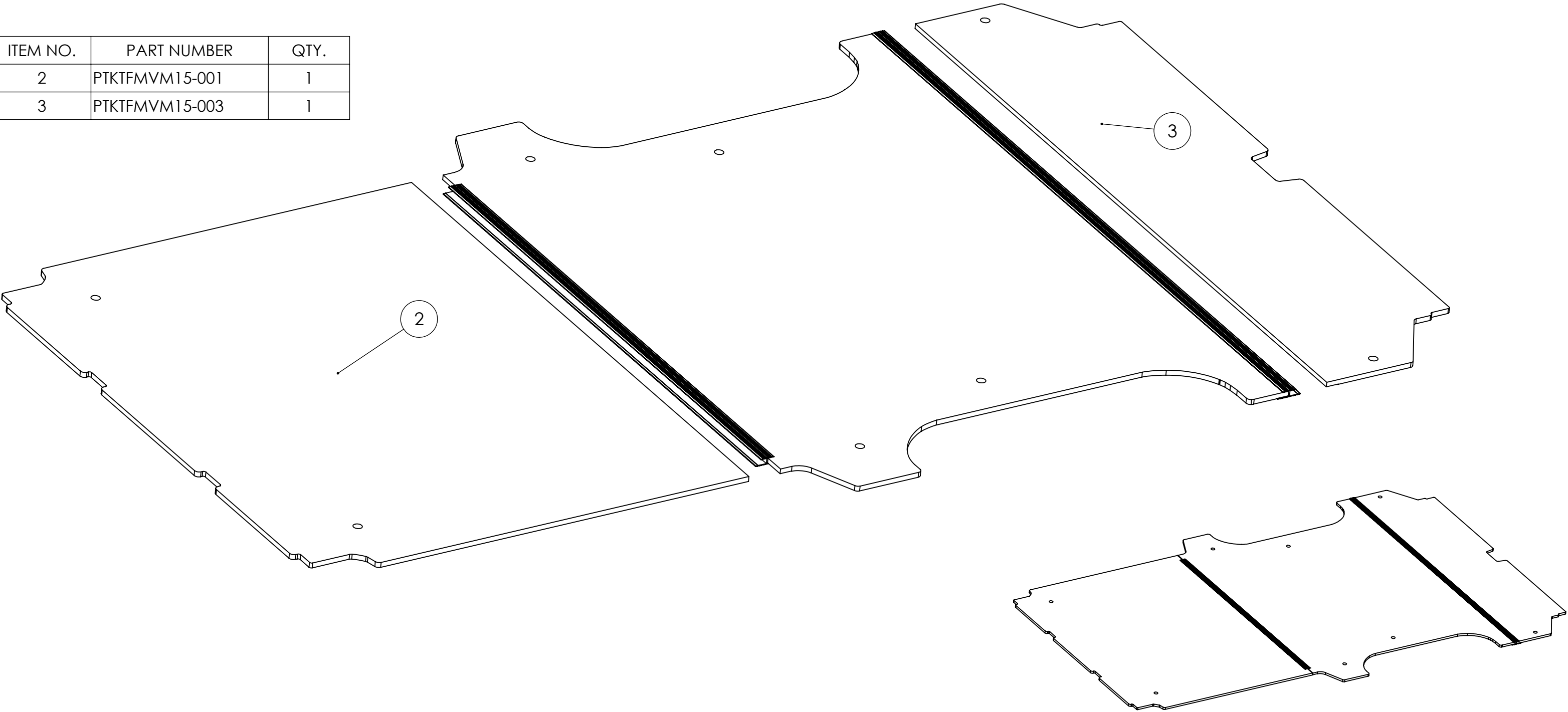

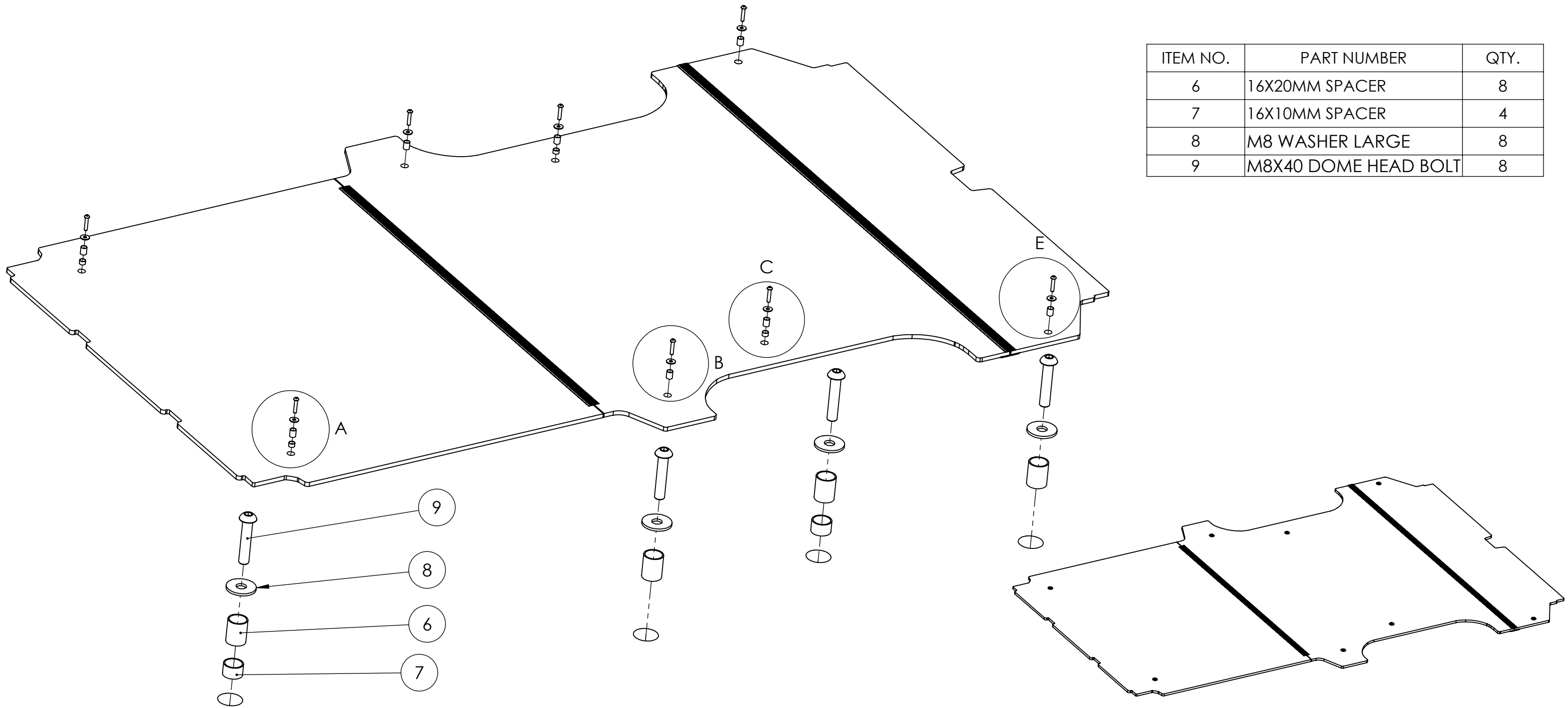

ITEM NO.	PART NUMBER	QTY.
6	16X20MM SPACER	8
7	16X10MM SPACER	4
8	M8 WASHER LARGE	8
9	M8X40 DOME HEAD BOLT	8

9- PLACE SPACERS INTO DESIGNATED HOLES AS PER DIAGRAM ABOVE.  
10- PLACE WASHER OVER SPACERS AND SECURE USING M8 BOLT.

ITEM NO.	PART NUMBER	QTY.
4	PTKTFMVM15-004	2
5	PTKTFMVM15-005	2
6	ILF-JOINER-1252	1
7	ILF-JOINER-1648	1
12	SCREW 10GX1/2	16

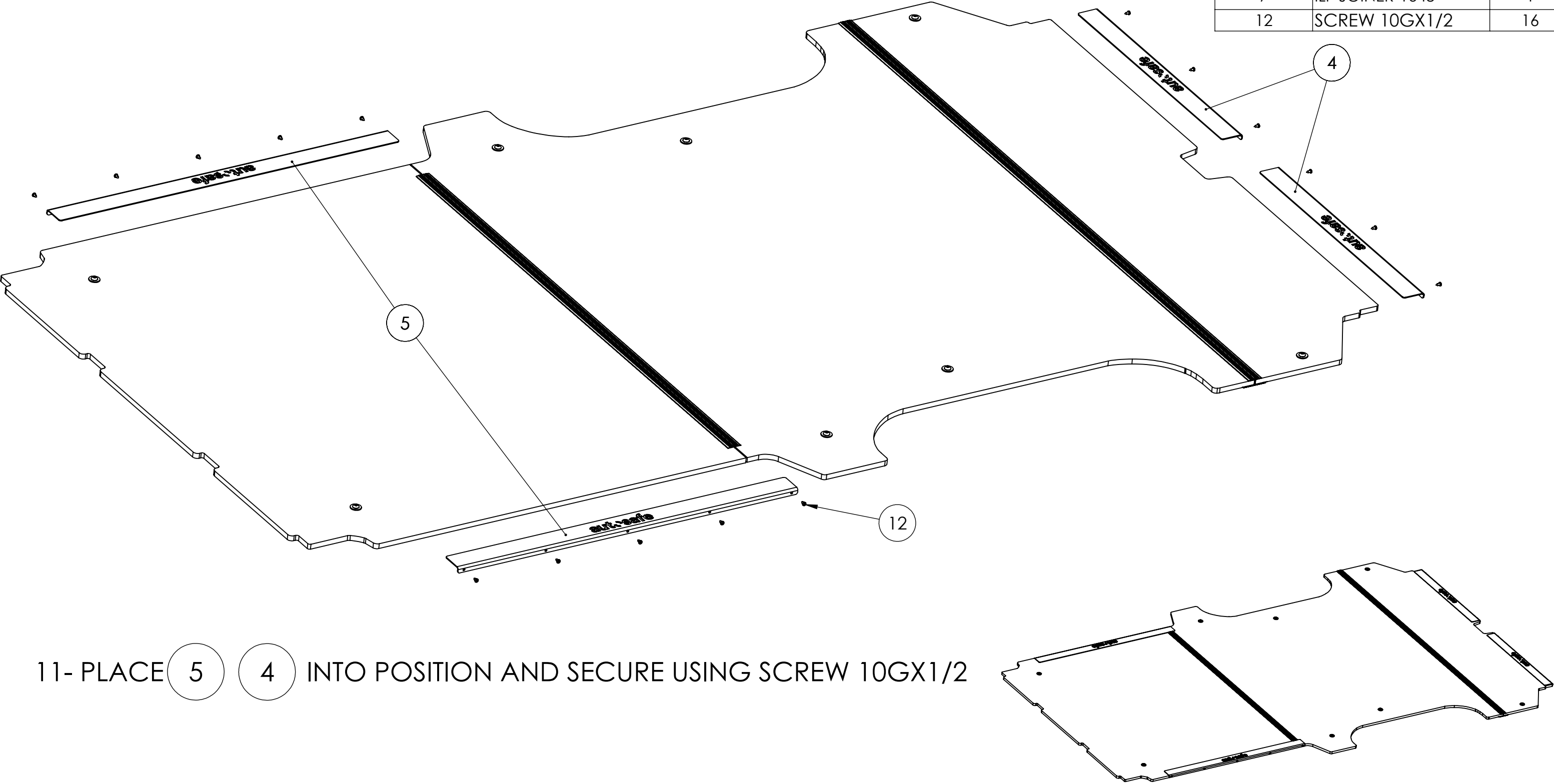

11- PLACE 5 4 INTO POSITION AND SECURE USING SCREW 10GX1/2