

ITEM NO.	PART NUMBER	DESCRIPTION	QTY.
1	PTKTFVWCL18-001		1
2	PTKTFVWCL18-003		1
3	PTKTFVWCL18-004		1
4	PTKTFVWCL18-002		1
5	STEP CAP 1090	1090 CAP ALLOY	1
6	STEP CAP 1315	1315 CAP ALLOY	1
7	JOINER 1370	1370 12MM JOINER ALLOY	1
8	JOINER 1770	1770 12MM JOINER ALLOY	1
9	JOINER 1580	1580 12MM JOINER ALLOY	1
10	M8 x 60 - 60N	M8X60 DOME HEAD BOLT	24
11	16 x 25mm spacer	Steel Spacer	24
12	16 x 10mm spacer		8
13	16 x 6mm spacer		16
14	14-14x1" Self-Tappers		10
15	14gx1&3/4" Self-Tappers		1

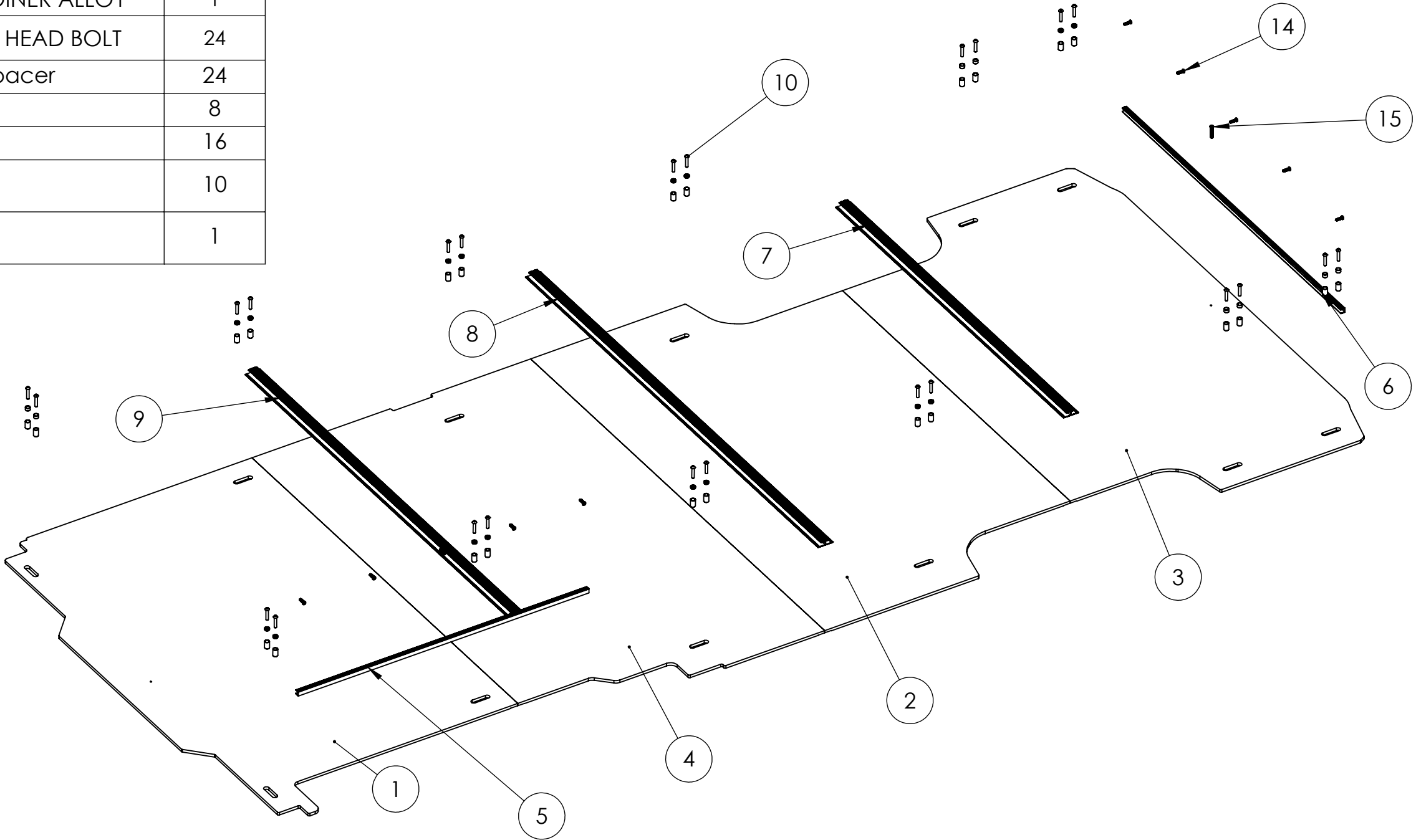

1-REMOVE ALL FACTORY TIE POINTS AND BOLTS FROM CARGO ARE.



1-FIT 1370 12MM JOINER ALLOY TO REAR BOARD ENSURING
LARGE FLANGE OF ALLOY IS AGAINST REBATE IN BOARD.
2-PLACE REAR BOARD INTO REAR OF VEHICLE. ENSURE LARGE
FLANGE IS FACING DOWN.

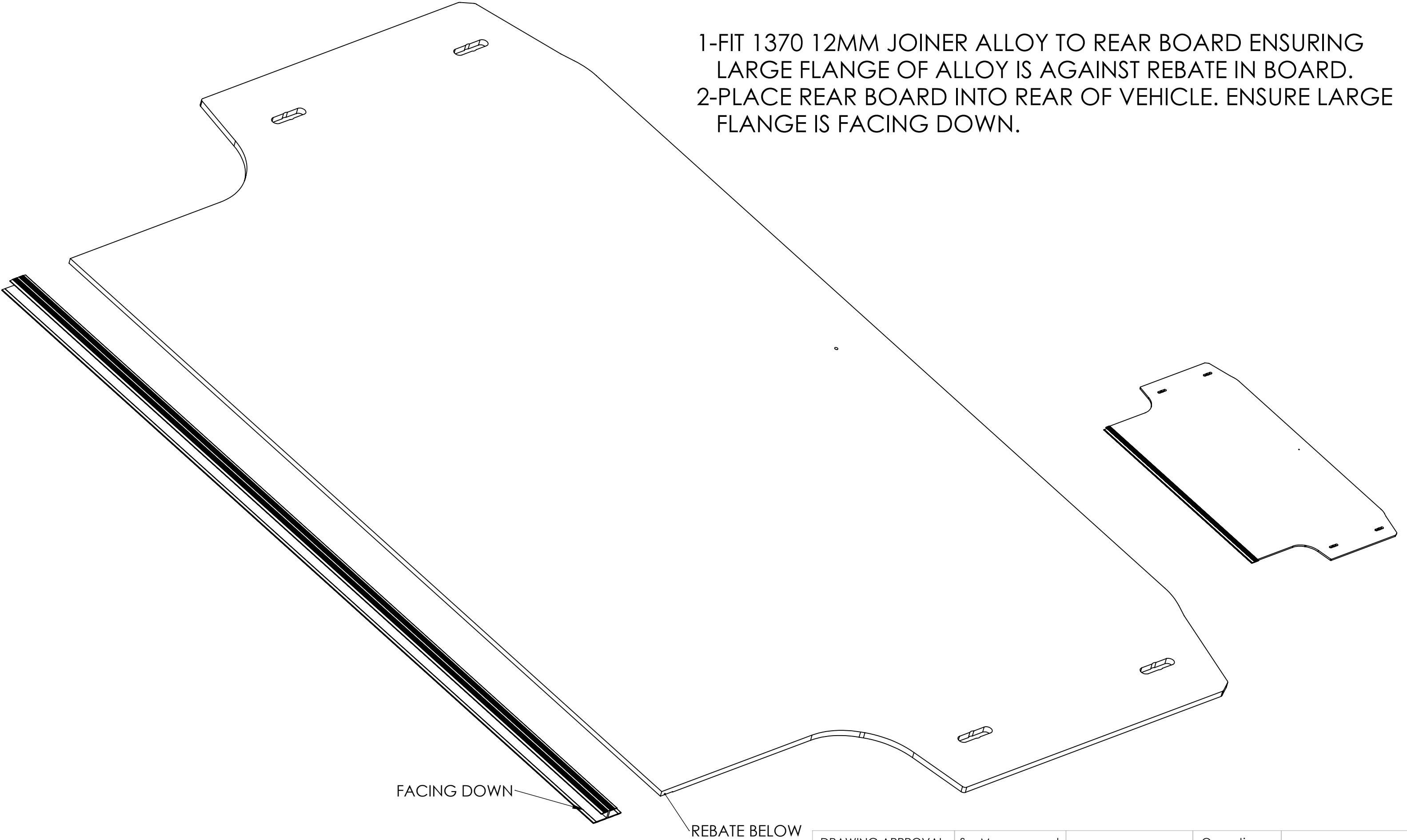

FACING DOWN

REBATE BELOW

1-FIT 1770 12M JOINER ALLOY TO MIDDLE REAR BOARD.
2-PLACE MIDDLE REAR BOARD INTO VEHICLE ENSURING
CORRECT MATING WITH 1370 JOINER

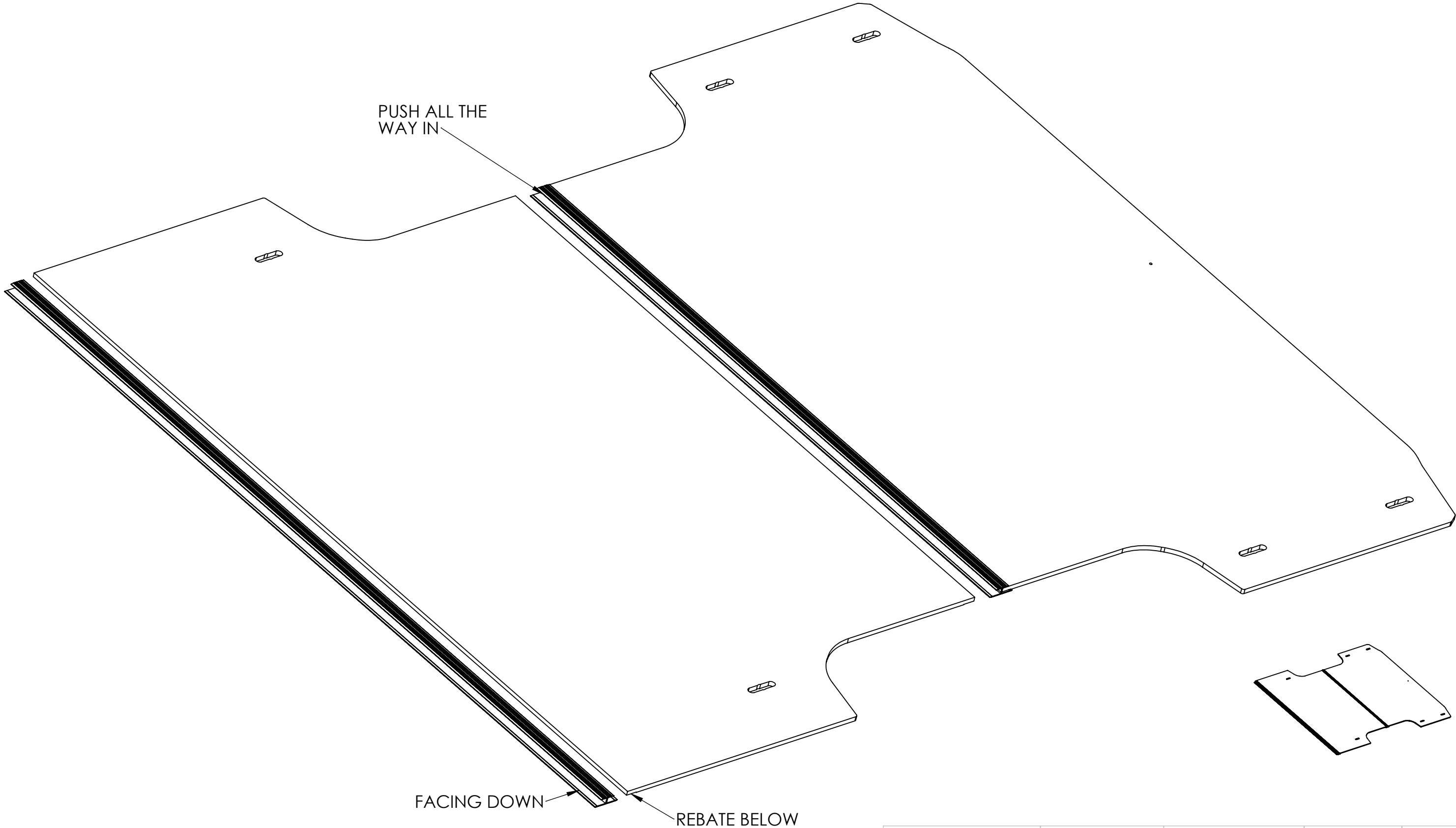

1-FIT 1580 JOINER TO MIDDLE FRONT BOARD ENSURING END OF JOINER IS FLUSH WITH DRIVERS SIDE OF BOARD.
2-PLACE MIDDLE FRONT BOARD INTO VEHICLE ENSURING CORRECT MATING WITH1770 JOINER

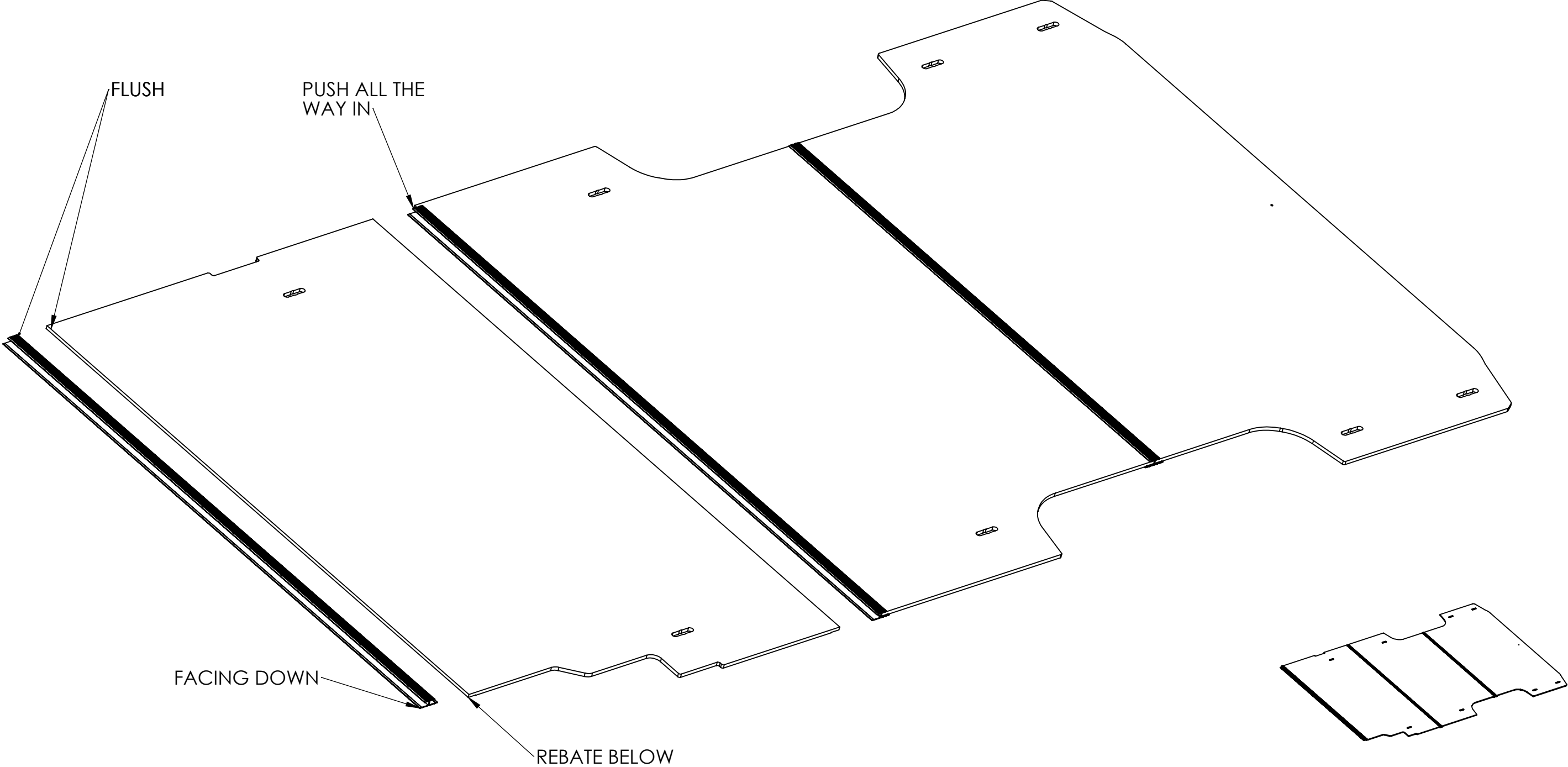

- 1-PLACE FRONT BOARD IN POSTION ENSURING TRAILING EDGE IS SITTING ON TOP OF JOLINER (LARGE DIAGRAM)
- 2-LIFT MIDDLE FRONT AND FRONT BOARD TOGETHER UNTIL FRONT BOARD FALLS INTO JOINER (SMALLER DIAGRAM)
- 3-PUSH BOARDS DOWN INTO POSITION.

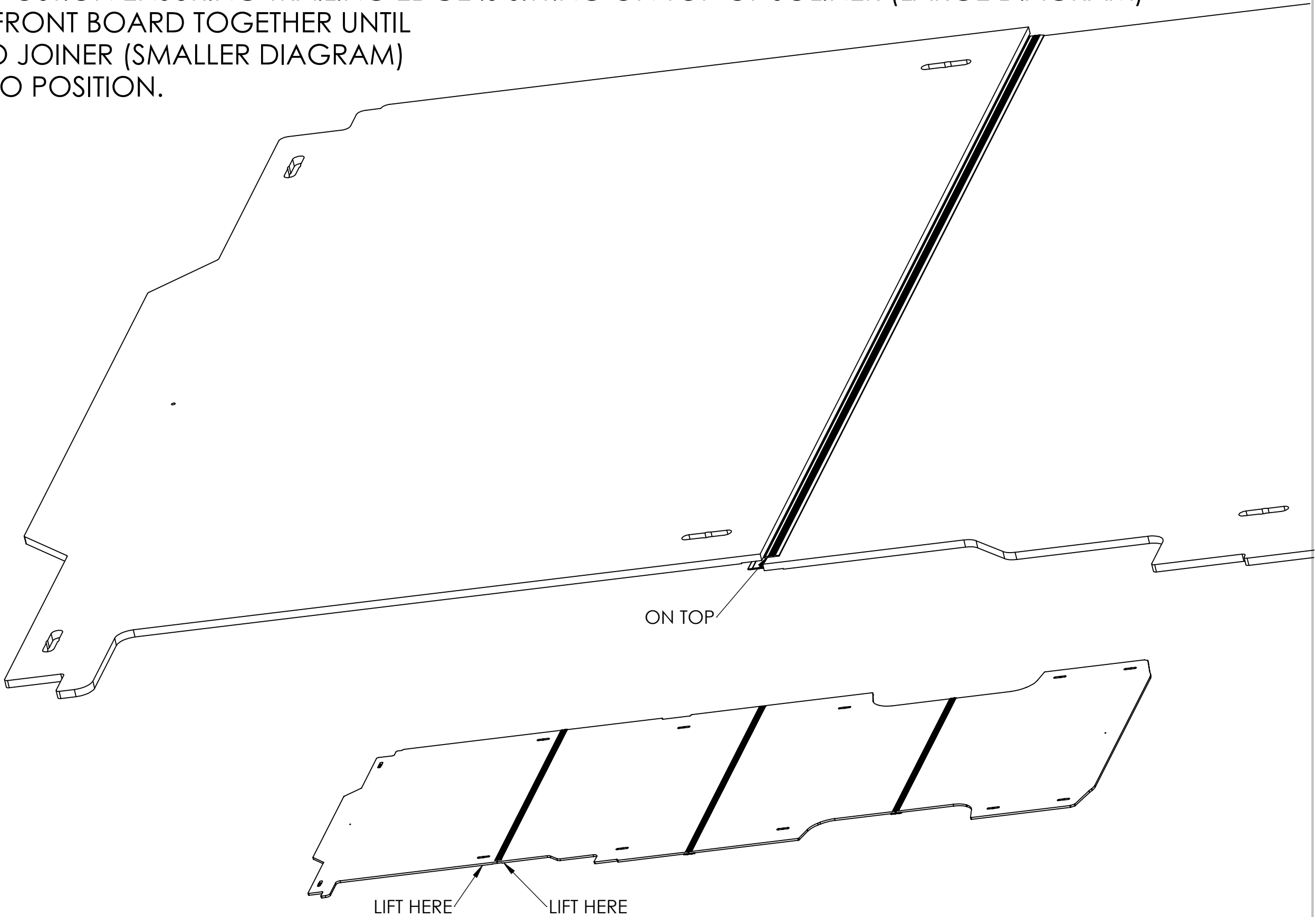

1-ADJUST ALL BOARDS UNTIL EDGES LINE UP WITH EACH OTHER.
2-REFIT FACTORY TIE DOWN POINTS USING M8X60 DOME HEAD BOLTS
INCLUDE SPACERS IN POSITIONS SHOWN. DO NOT OVER TIGHTEN.

POSITION A - 1 x 10mm SPACER & 1 x 25mm SPACER PER BOLT
POSITION B - 1 x 6mm SPACER & 1 x 25mm SPACER PER BOLT

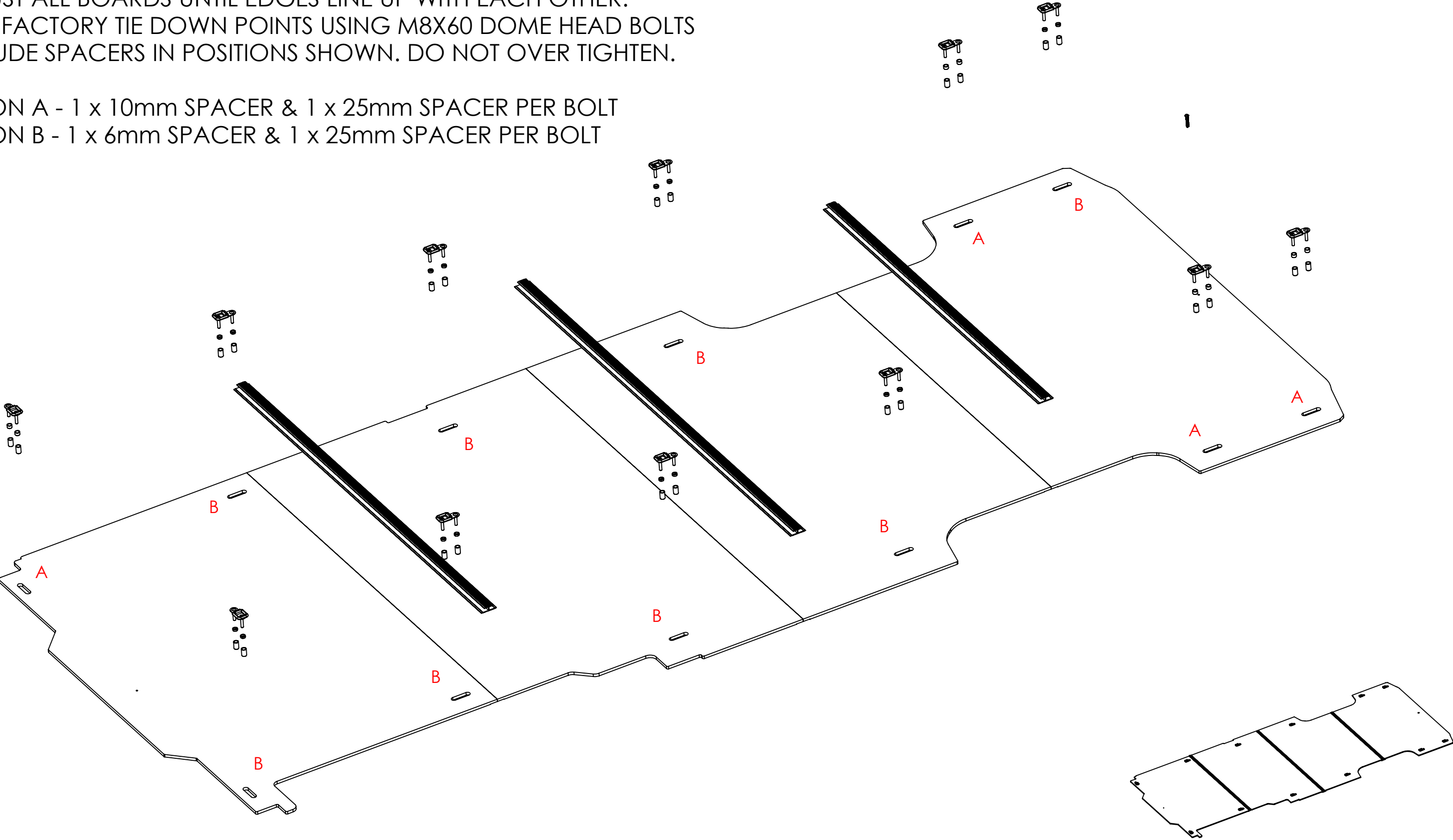

1-FIT END CAPS USING SCREW 14g x 1" Self-Tappers
2-SCREW REAR FLOOR DOWN USING 14gx1 & 3/4" Self-Tapper



THE INFORMATION CONTAINED IN THIS DRAWING IS THE
SOLE PROPERTY OF AUTOSAFE. ANY REPRODUCTION IN
PART OR AS A WHOLE WITHOUT THE WRITTEN PERMISSION
OF AUTOSAFE IS PROHIBITED.

Drawn by: P.LUIS
Scale SCALE: 1:50
Date 2/03/2022

DRAWING APPROVAL	Snr.Management:	Operations:
Filename: PTKTFCL18		
Vehicle VW CRAFTER LWB 2018	Job no:	
Material	Color	Part no: